

DWG.NO. HW2380265

Type	Specification
YR-1-06VXCP10-A00	Built-in Air Hoses, Ethernet and I/O (8 wires) Cables

Item	Model	MOTOMAN-HC10DTP
Configuration	Vertically Articulated	
Degree of Freedom	6	
Payload	10kg	
Repeatability *1	0.05mm	
Range of Motion	S-Axis (Turning) *3	-210° - +210°
	L-Axis (Lower Arm)	-180° - +180°
	U-Axis (Upper Arm)	-290° - +290°
	R-Axis (Roll)	-210° - +210°
	B-Axis (Pitch/Yaw)	-180° - +180°
Maximum Speed *4	T-Axis (Twist)	-210° - +210°
	S-Axis	2.27rad/s, 130°/s
	L-Axis	2.27rad/s, 130°/s
	U-Axis	3.14rad/s, 180°/s
	R-Axis	3.14rad/s, 180°/s
Allowable Moment	B-Axis	4.36rad/s, 250°/s
	T-Axis	4.36rad/s, 250°/s
	R-Axis	27.4N·m (2.8kgf·m)
Allowable Inertia (GD ² /4)	B-Axis	27.4N·m (2.8kgf·m)
	T-Axis	9.8N·m (1.0kgf·m)
	T-Axis	0.78 kg·m ²
Mass	48kg	
Protection Rating	IP20	
Mounting Method	Floor-, Wall-, Tilt-, Ceiling-mounted	
Ambient Conditions	Temperature	0 °C - 40 °C
	Humidity	20%RH - 80%RH (Non-Condensing)
	Vibration Acceleration	4.9m/s ² (0.5G) or less
	Altitude	1000m or less
	Fitness for Installation	0.5mm or less
Others	<ul style="list-style-type: none"> Free from dirt, dust, oil soot, or water. Free from explosive and corrosive gas or liquid. Free from excessive electrical noise (plasma). Free from strong magnetic field. 	
Power Requirements *5	1.0kVA	
Applicable Controller	YRC1000/YRC1000micro	

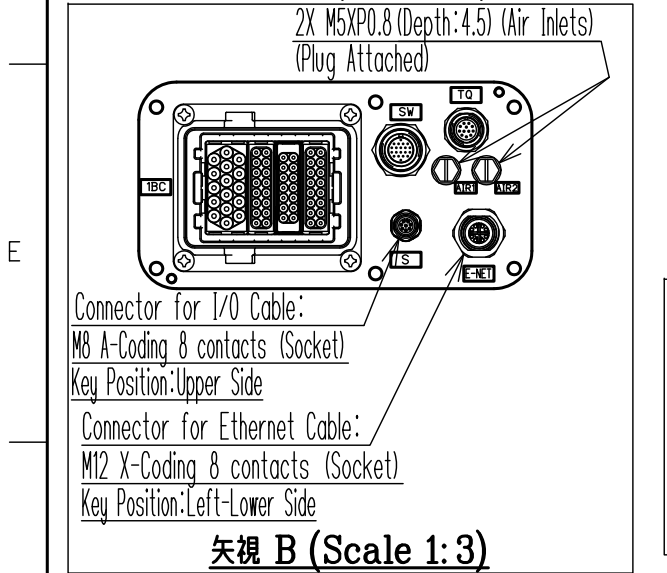
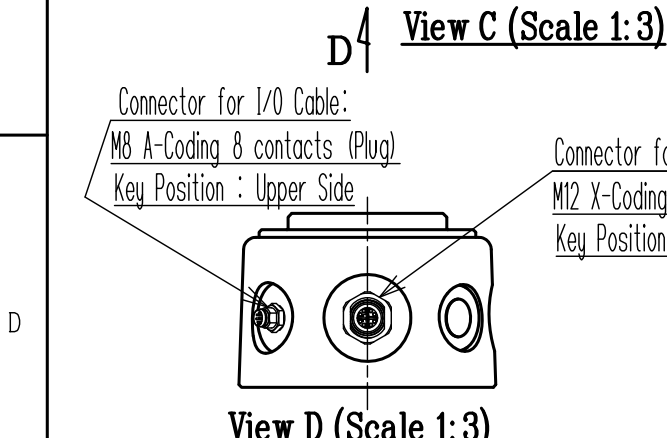
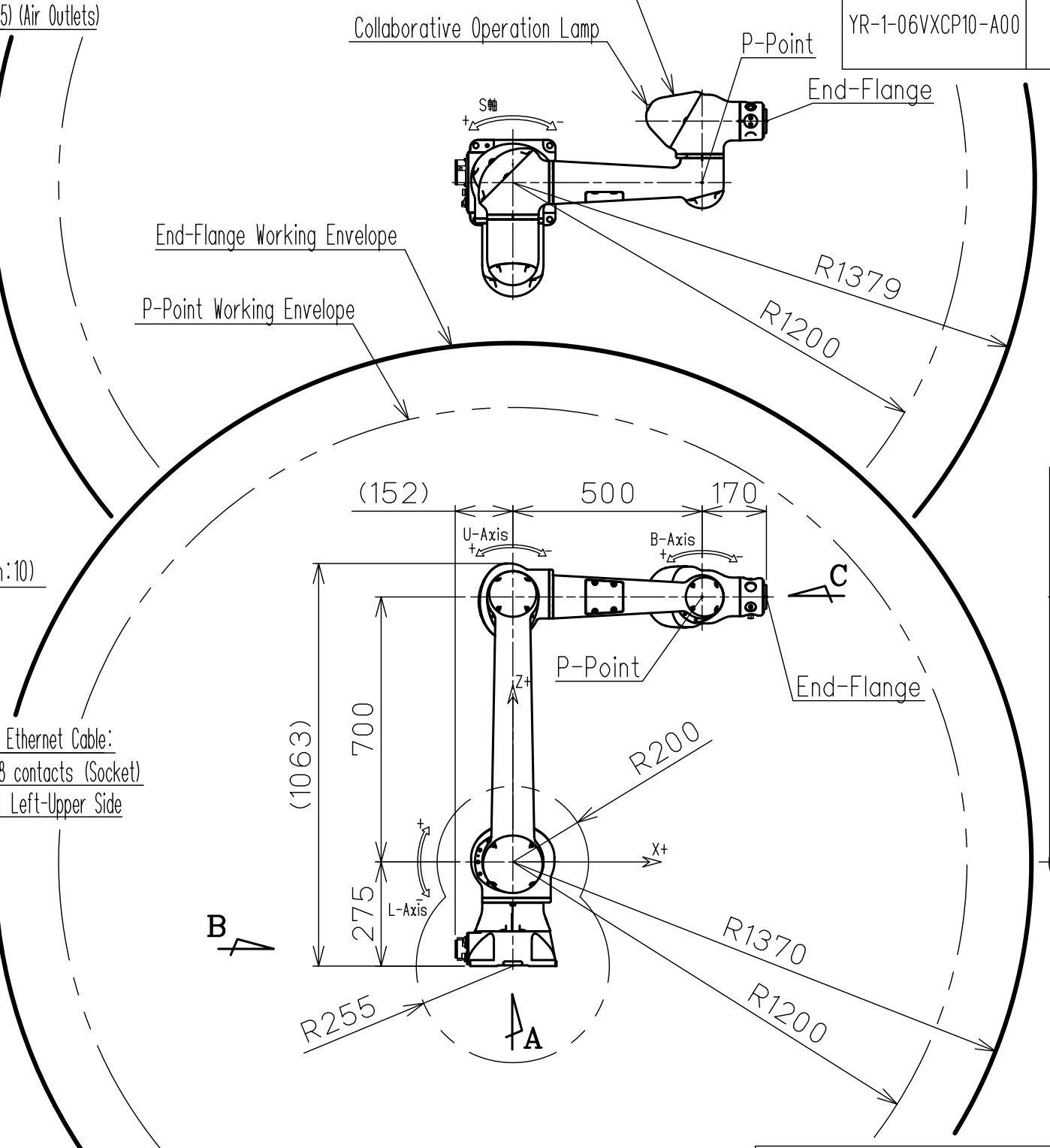
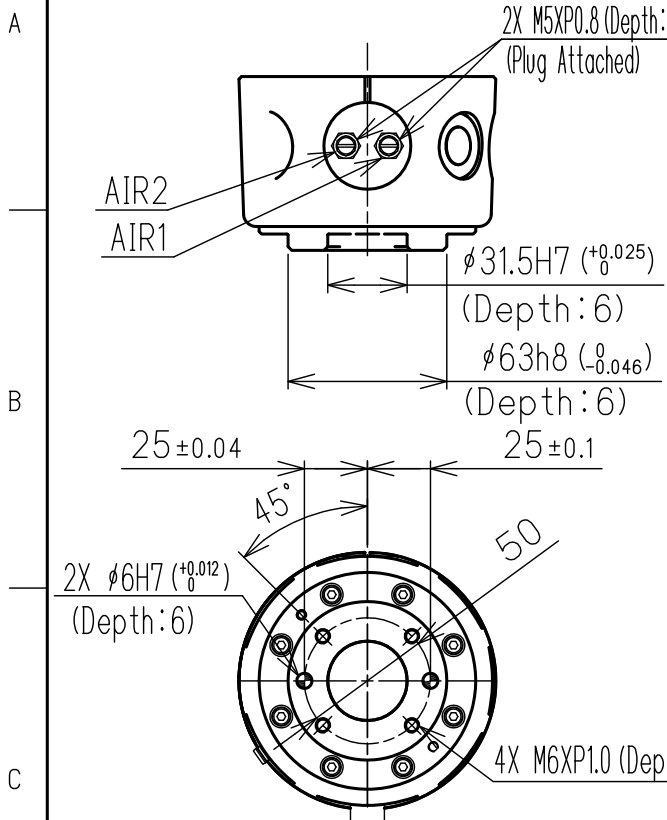

Detail of Connector for Ethernet Cable

Connector-Base Side	End-Flange Side
1	1
2	2
3	3
4	4
5	5
6	6
7	7
8	8

Detail of Connector for I/O Cable

Connector-Base Side	End-Flange Side
1	1
2	2
3	3
4	4
5	5
6	6
7	7
8	8

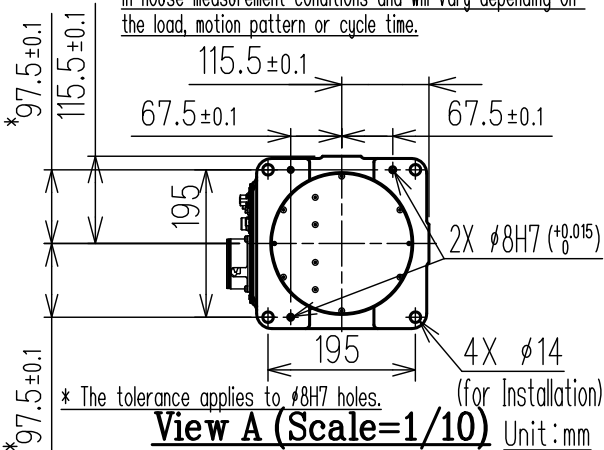
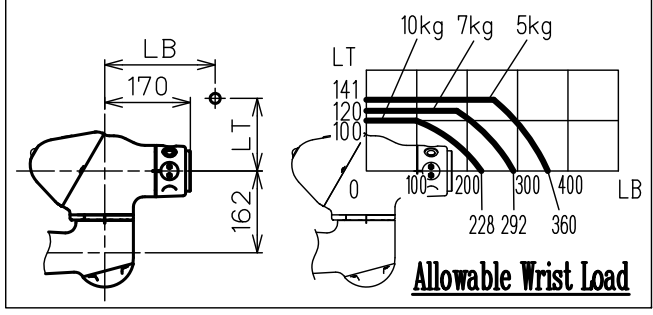

Note:
 1. All rights reserved.
 2. Please note that the data is subject to be deleted without advance notice.
 3. No warranty is given in relation to the data including the specification.
 4. We are not responsible for any damages or loss caused by the use of the data.

FOR STUDY PURPOSE ONLY

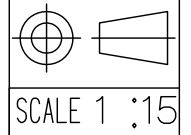

YASKAWA
 株式会社 安川電機

Reference Drawing

TITLE MOTOMAN-HC10DTP
 DIMENSION DIAGRAM

DRWN DATE Jun. 2, '21
 DWG.NO. HW2380265
 SIZE A3