

YIND - 500KG Compact Single Axis Positioner

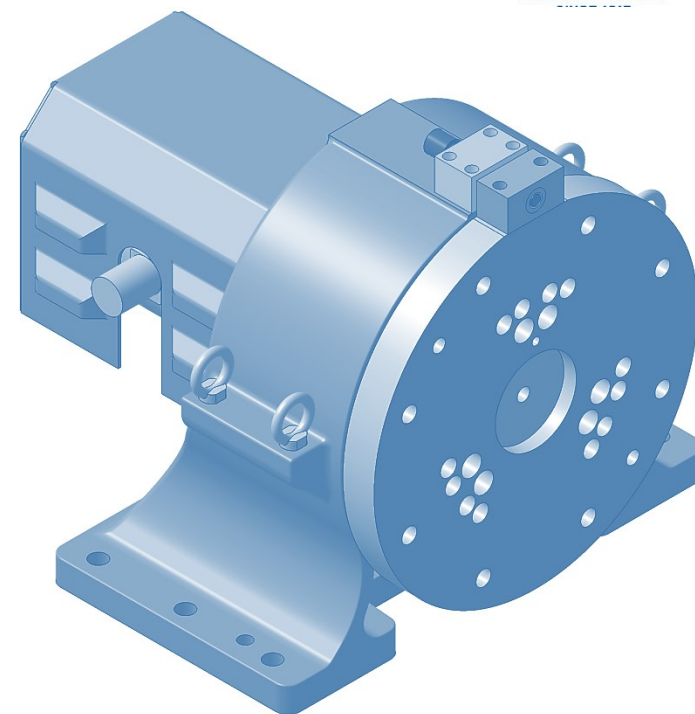
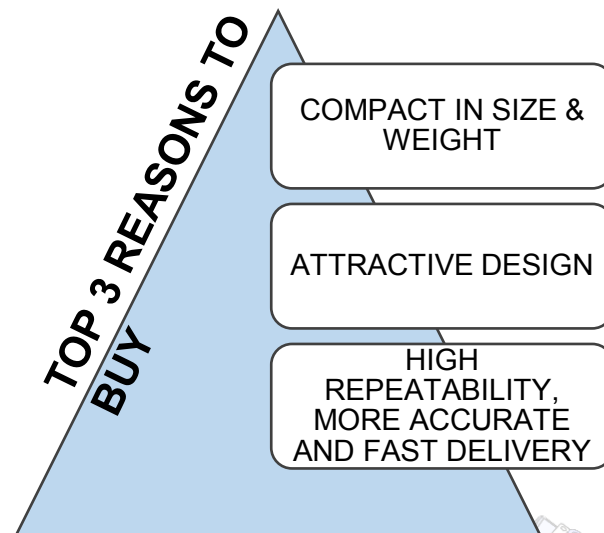

***“ For Robotics Welding Application –
Standardized Proven Positioner Solution with
Low backlash Gear Units and casted housing”***

The Positioners are optimized to be used for manipulating of work pieces in arc welding applications. The axes can be fully coordinated with the robot when programming as well as during operation

Specification & Load Conditions:

Standard Specification:

Payload - One End Supported	500 KG
Payload - Both End Supported	1000 KG
Inertia	100 kgM ² *
Rated Torque	718 Nm
Allowable Moment Load	2150 Nm
Allowable Overhang	300 (Please refer the Load Graph-1)
Position Accuracy at Gearbox centre	1 Arc.min
Maximum Speed	120 (°/s)
Acceleration time	0.60 s
Power Rating	1 kVA
Motor	SGMRV-13ANA-YR11 *
Flange Diameter	260 mm
Approximate Mass	60 kg
Mounting scope	Base, Wall
Motor Isolation	Yes

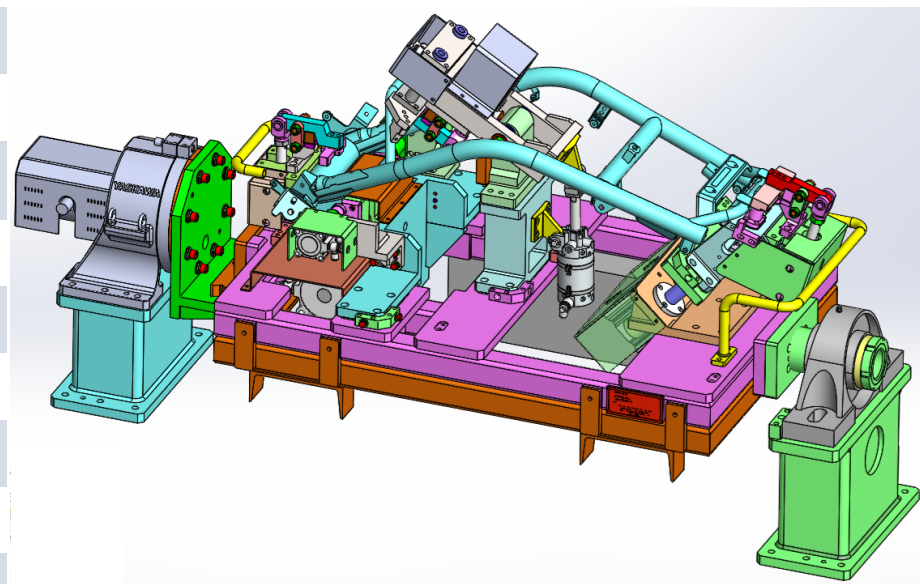

Load Graph for One-End supported (Without Tailstock):

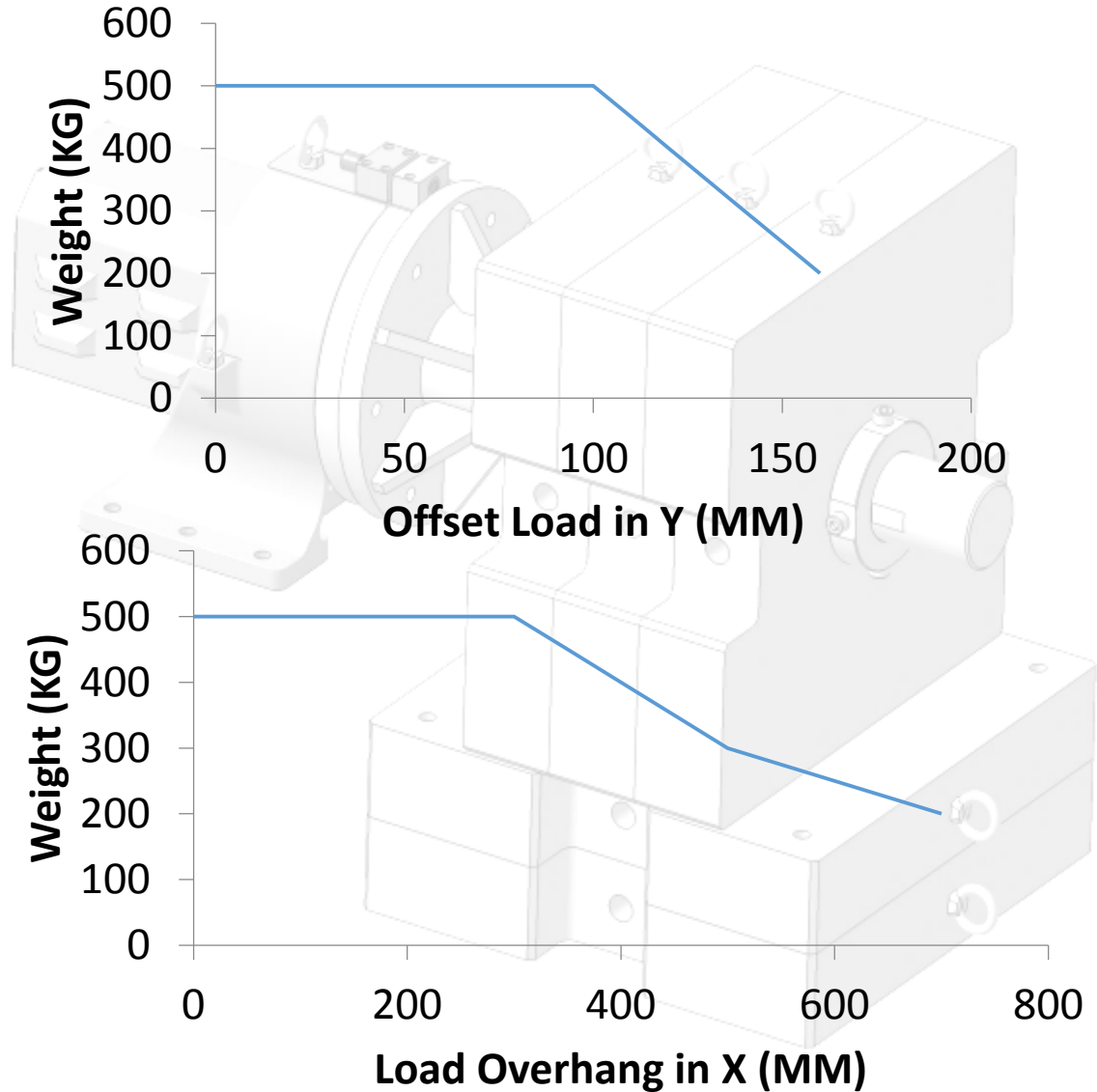
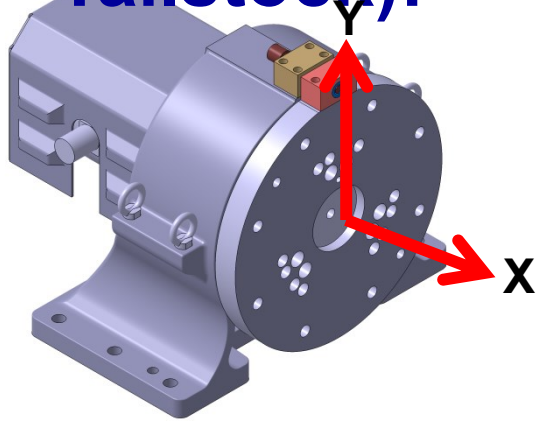

Load Graph for Both-End supported (With

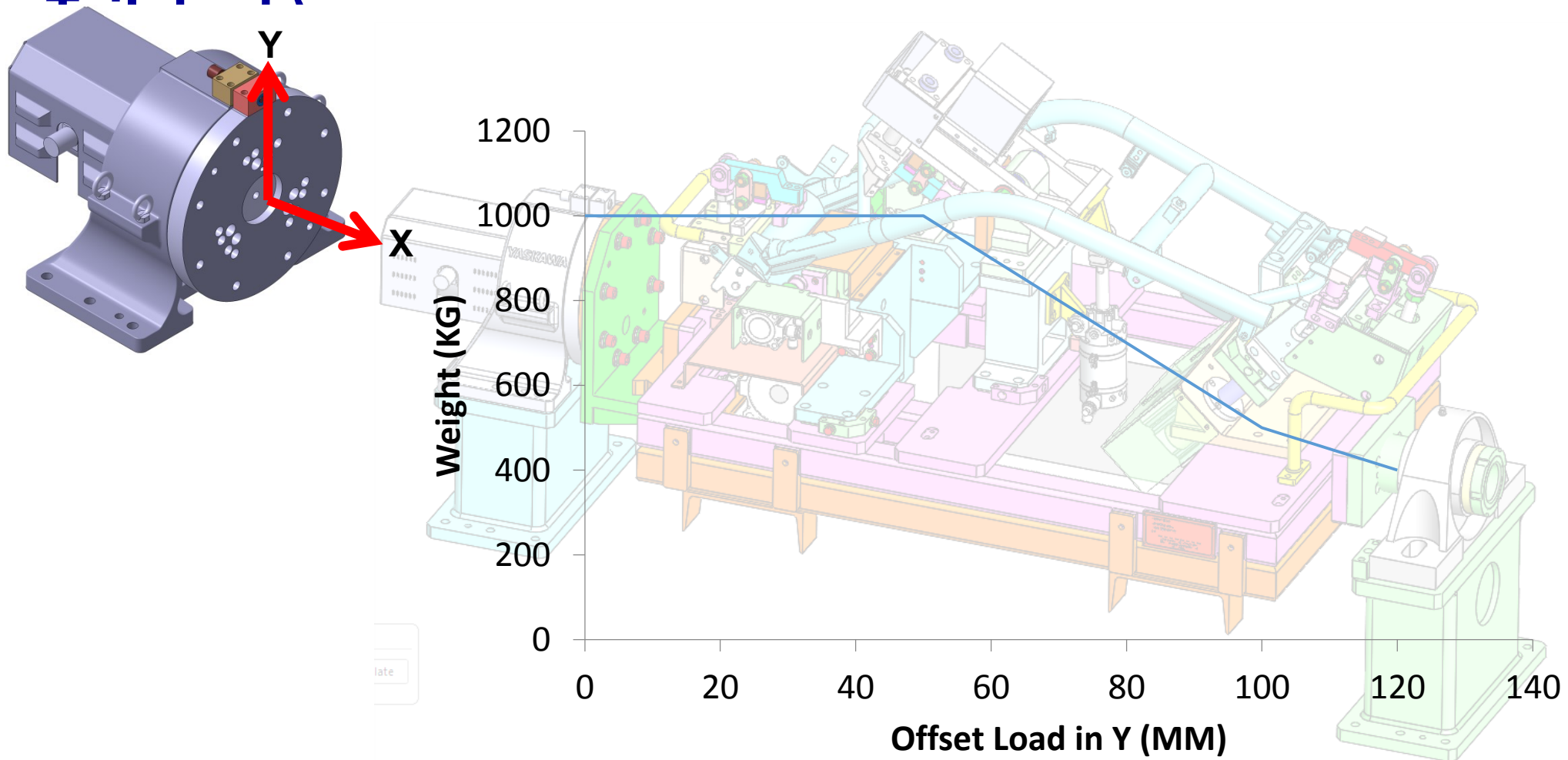

Design Concept & Features:

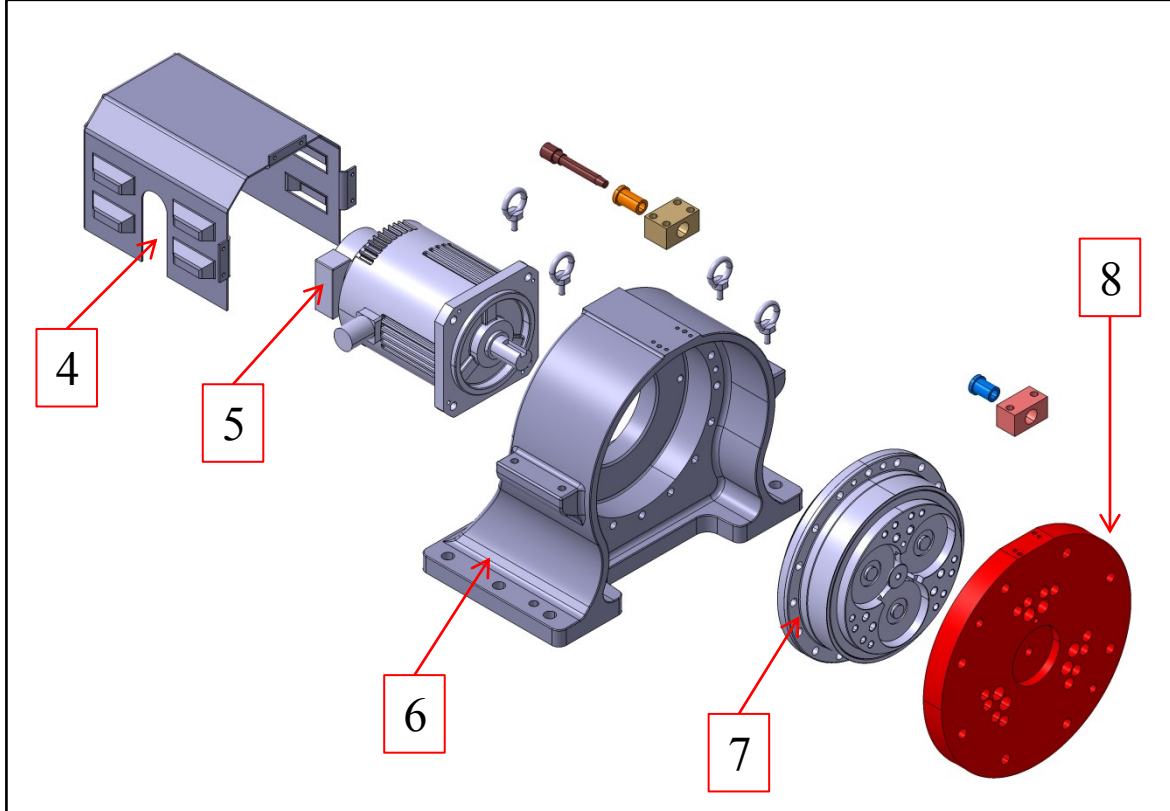

1. Grease Out port
2. I-Bolts to lifting
3. Zero Positioning with Datum Pin
4. Motor Cover
5. Servo Motor – 1.3KW
6. Casted Bracket
7. Reducer – RV-80E
8. Output Flange to customer
9. Grease In Port

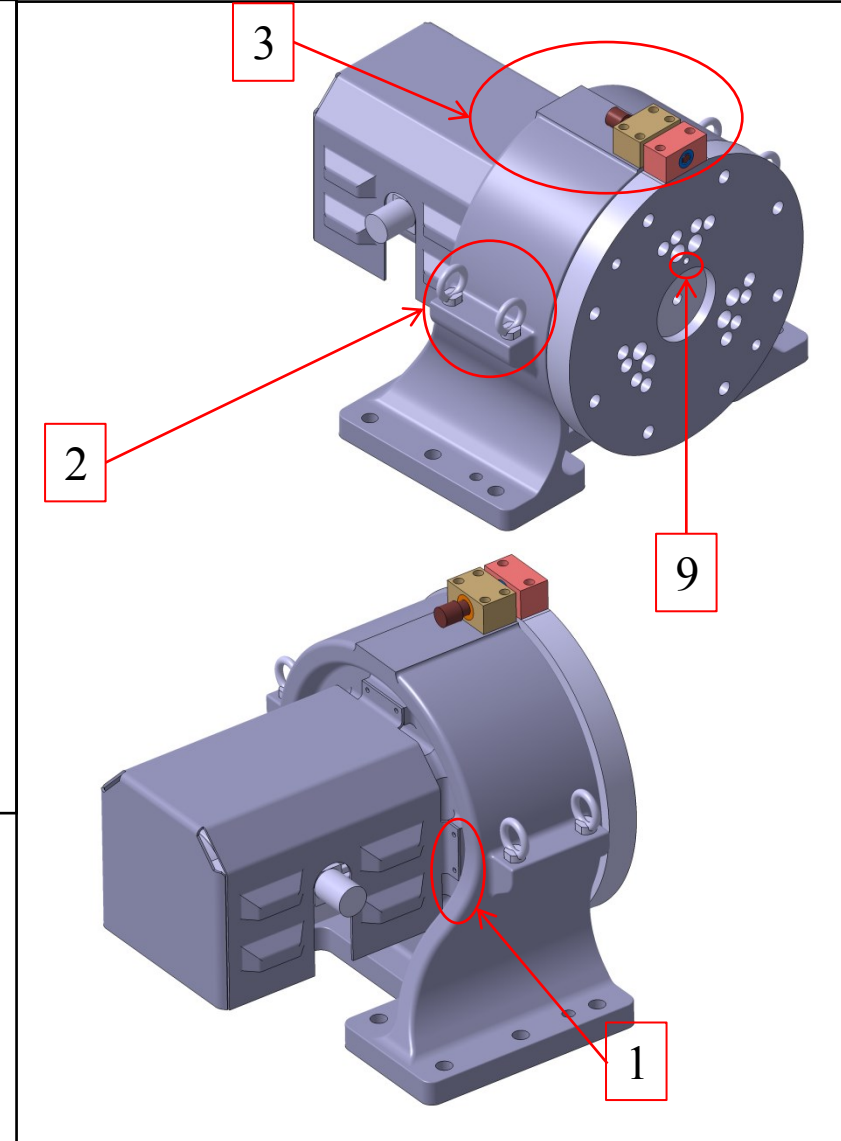

Design Concept & Features:

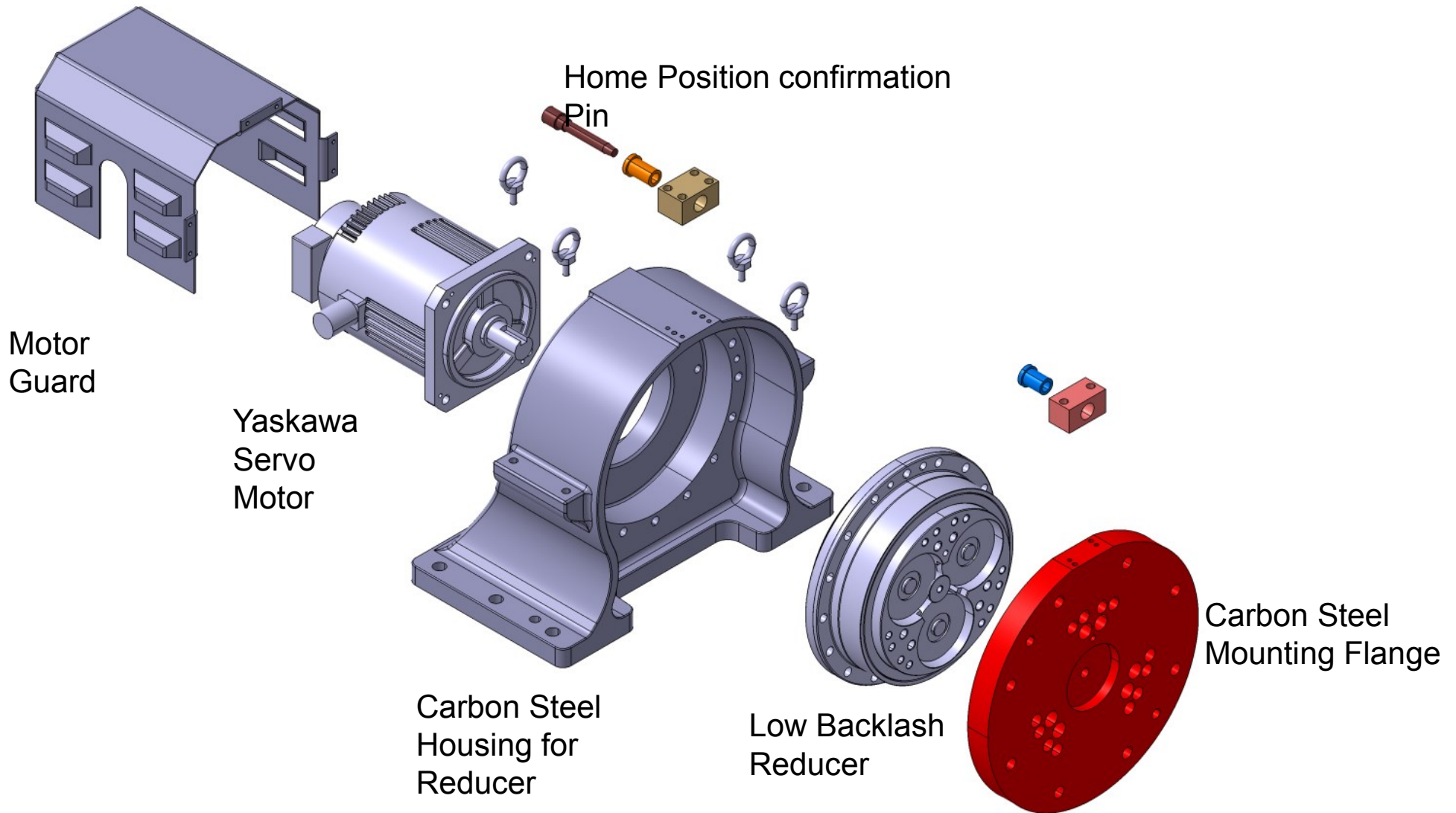

Servomotor Isolation Scope:

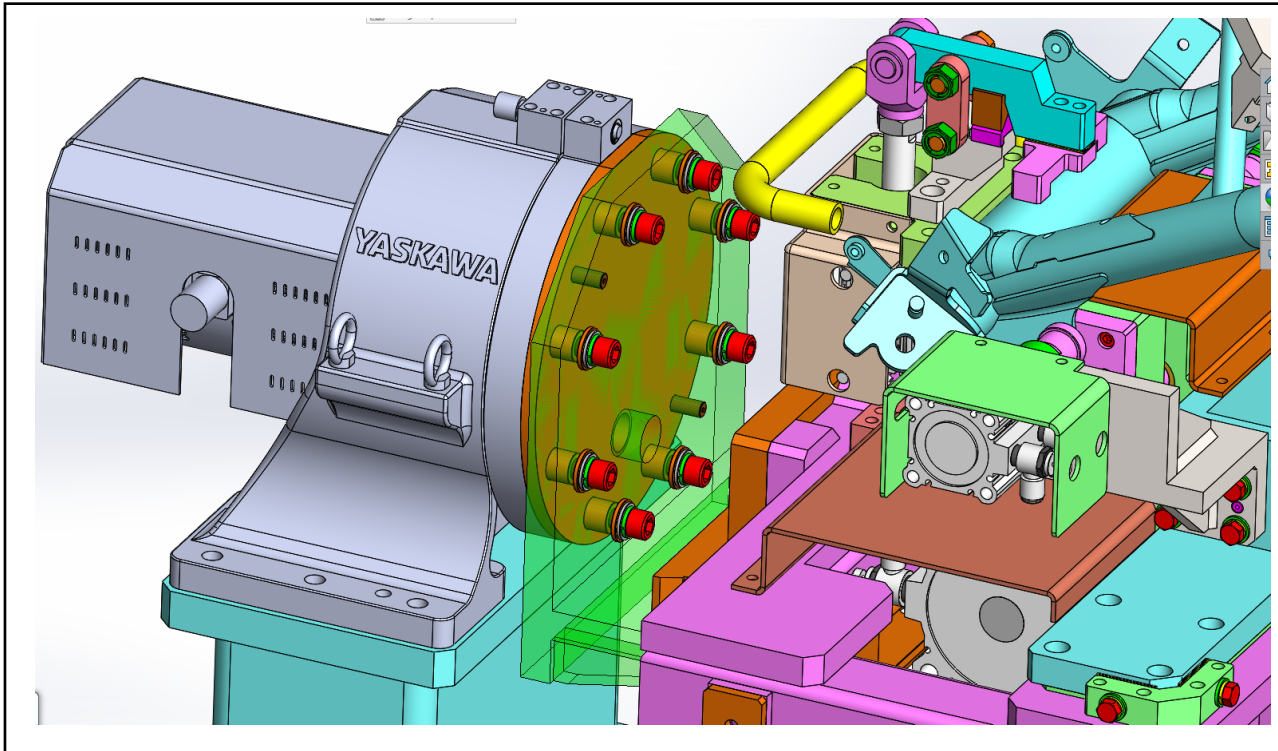

For Isolating the Positioner/Servo Motor from the welding fixture, Yaskawa will provide the Isolation kit with the Positioner. The Isolation kit can be installed by the Customer/Integrator when the time of System integration.

Isolation Procedure and Details:

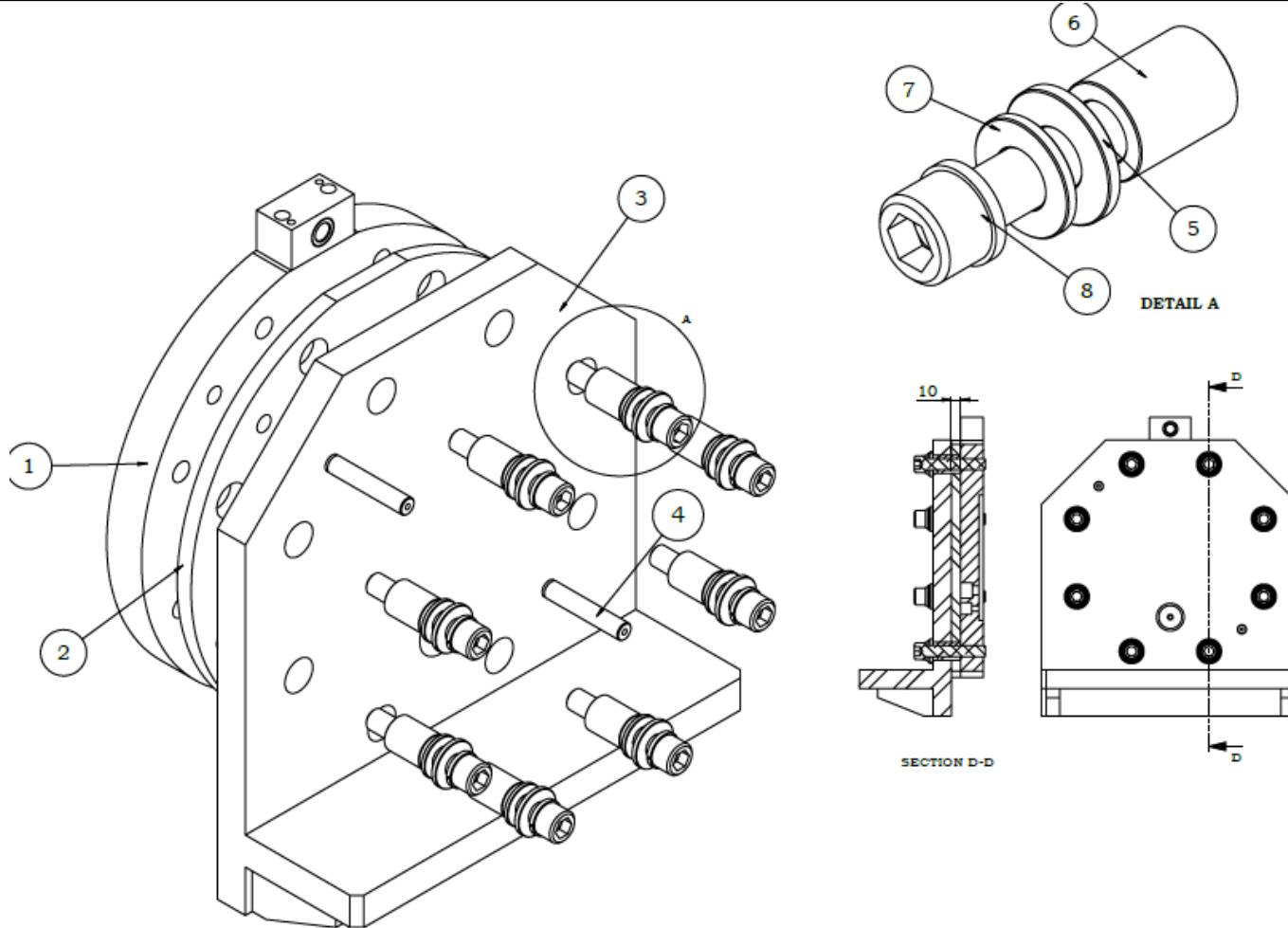

The detailed installation procedure with drawing will be available with the Positioners Drawing.

PS-500C Highlights:

- **Compact design with Small foot print**
- **High Accuracy with Maximum Backlash of 1-Arcmin**
- **Low-Weight**
- **Optimized Installation Space**
- **Proven Isolation technology for welding automation**
- **Ensures 100% Endurance test with Cantilever full-Load condition before dispatch.**

Outer Dimensions :

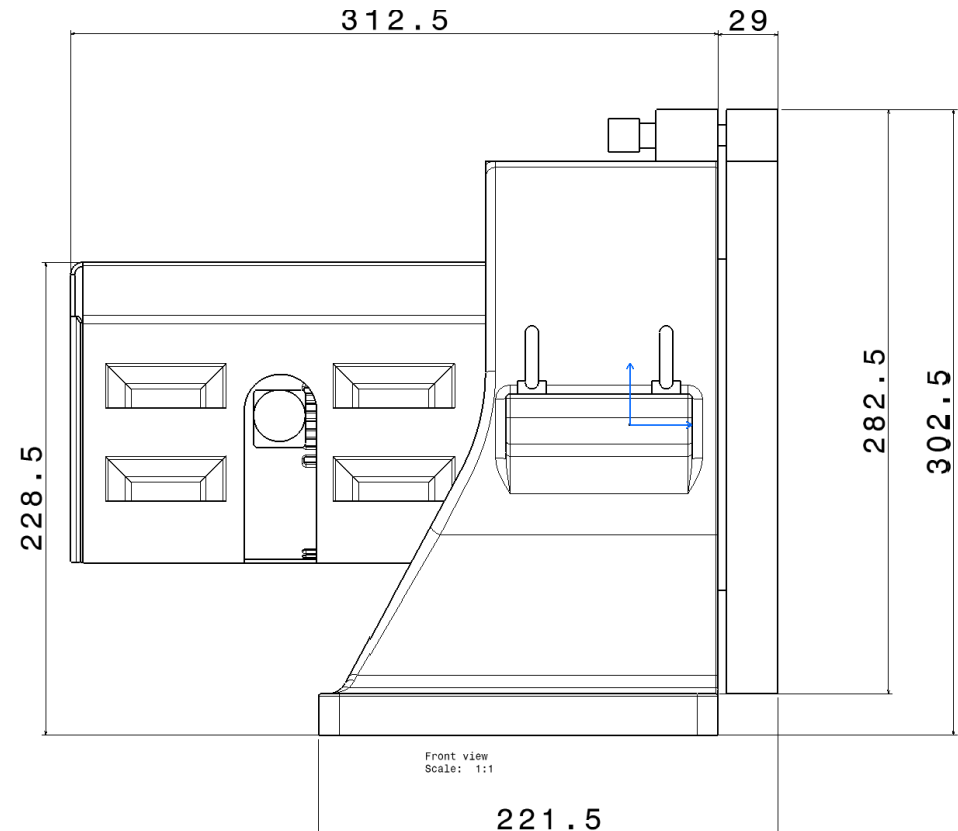
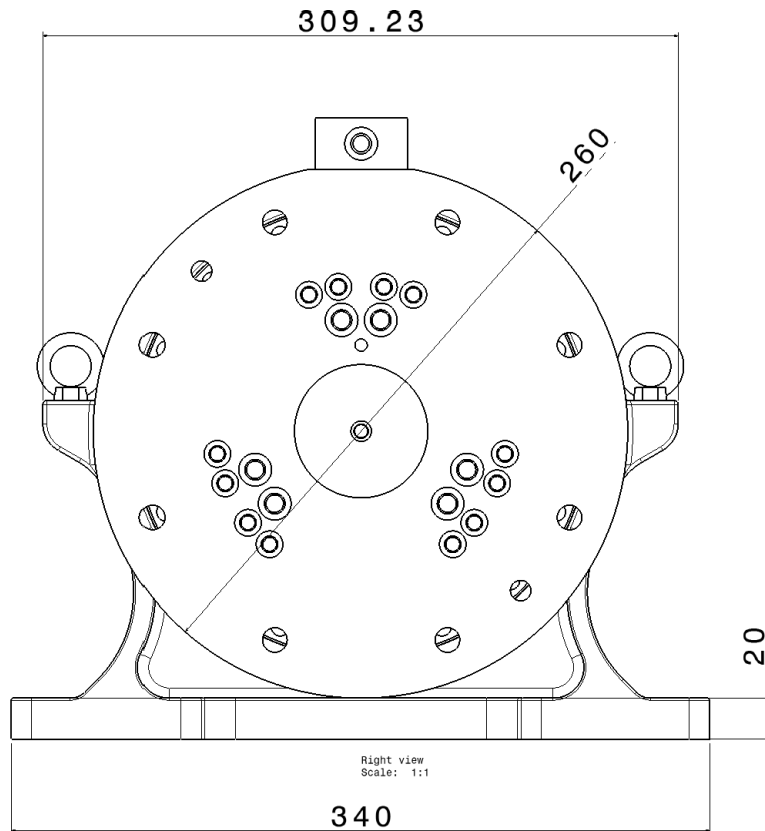

NOTE: The Product is not still released, Design and Design Analysis had completed and Manufacturing in Progress. The Specification & Dimensions will be Fixed only once the Physical Load Testing got completed. **This Presentation is for only Sales Promotion purpose.**

THANK YOU...😊

